

# KÄRCHER

makes a difference



## Cleaning Solutions for Your Home

Solusi Kebersihan Rumah Anda

2016

# Cleaning Solutions for Over 80 Years

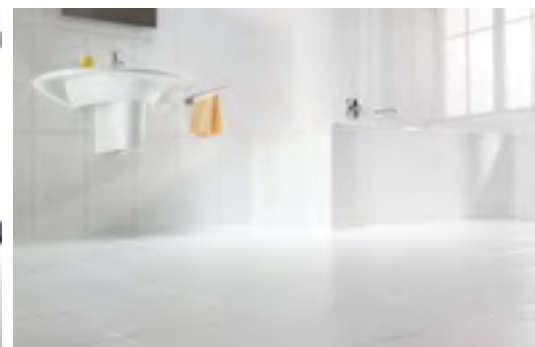

Since 1935 Kärcher has stood for innovation, perfection and quality without compromises. Our pursuit of creative solutions to problems bring about new developments that make work more efficient and life easier. Kärcher provides a versatile system of machines and accessories for convenience around the house and garden. For example, powerful and energy-efficient pressure washers for all conceivable applications including the Aircon pressure washer. Durable wet and dry vacuum cleaners for all-purpose applications both indoors and outdoors. Refined steam cleaners, vacuum cleaners, cordless electric brooms for impeccable cleanliness around the house. Try them and see for yourself!

*Sejak tahun 1935 Kärcher selalu mengutamakan inovasi, kesempurnaan dan kualitas tanpa kompromi. Berbagai upaya dalam mengembangkan solusi kreatif membawa perkembangan baru yang membuat pekerjaan lebih efisien dan hidup lebih mudah. Kärcher menyediakan sistem mesin dan aksesoris serba guna untuk keperluan membersihkan seputar rumah dan kebun. Misalnya, mesin pencuci bertekanan yang kuat dan efisien energi untuk semua aplikasi termasuk mesin pencuci AC. Pembersih vakum basah dan kering yang kuat untuk semua penggunaan di dalam dan di luar rumah. Pembersih dengan uap panas, penyedot debu, sapu listrik nirkabel untuk membersihkan area sekitar rumah. Coba dan buktikan sendiri!*

**Kärcher makes a difference.**



# Why Kärcher?

Since its beginning in 1935 the value-oriented family business Kärcher has developed into a worldwide brand offering its customers three strong attributes: top performance, innovation and quality. Today, Kärcher is the leading global provider of efficient, resource-saving cleaning systems, characterized by reliable, user-friendly products, strong service and an on-going commitment to the environment. Kärcher has cleaned Indonesian National Monument (Monas) in 1992 and 2014.

*Sejak dimulai di tahun 1935, Kärcher, bisnis keluarga berorientasi pada nilai-nilai telah berkembang menjadi merek internasional yang menawarkan 3 atribut penting kepada pelanggannya: kinerja terbaik, inovasi dan kualitas. Saat ini, Kärcher merupakan penyedia global terkemuka akan sistem pembersihan yang efisien, hemat sumber daya yang terpercaya, ramah lingkungan, dengan pelayanan dan komitmen yang tinggi terhadap lingkungan. Kärcher telah membersihkan Monumen Nasional (Monas) Indonesia pada tahun 1992 dan 2014.*



## Table of Contents

High Pressure Cleaners <i>Pembersih Air Bertekanan Tinggi</i>	<b>4</b>	Cordless Electric Broom <i>Sapu Listrik Nirkabel</i>	<b>12</b>
Wet & Dry Vacuum Cleaners <i>Pengisap kotoran basah &amp; kering</i>	<b>6</b>	Submersible Pump <i>Pompa Celup</i>	<b>13</b>
Dry Vacuum Cleaner <i>Pengisap kotoran kering</i>	<b>8</b>	Hose Reel <i>Selang Air</i>	<b>13</b>
Steam Cleaners <i>Pembersih dengan Uap Panas</i>	<b>10</b>	Home & Garden Accessories <i>Aksesoris Rumah &amp; Taman</i>	<b>14</b>
Window Cleaner <i>Pembersih Jendela</i>	<b>12</b>		



# Kärcher for Cleaner Indonesia

# High Pressure Cleaners

Whether it is tender care or powerful cleaning, Kärcher pressure cleaners offer the perfect solution for every outdoor cleaning task around your home. The compact units are reliable allies against smaller messes around the house and garden. Simple & convenient, the units outshine conventional cleaning that relies on a sponge, brush & bucket.

Baik perawatan yang ringan ataupun pekerjaan berat, pembersih Kärcher bertekanan tinggi memberikan hasil sempurna untuk kebersihan sekitar rumah. Unit padu andalan yang dapat diandalkan untuk membersihkan rumah & taman. Mudah dan nyaman, menggantikan pekerjaan manual yang menggunakan busa, sikat & ember.



## Special Features

- Robust & energy efficient
- Vario Power
- 50% more power dirt blasting
- Short trigger gun for narrow areas
- 360° swiveling Vario short nozzle
- Integrated detergent suction hose
- Velcro tape for easy storage and carrying

Product (order n.)		K 1 (1.600-005.0)	K 2.050 (1.601-652.0)	K 2.360 (1.601-686.0)	K 2.420 Air Con (1.601-110.0)		
<b>Technical Data</b>							
Pressure (max.)	bar	90	100	120	100		
Flow rate (max.)	l/h	300	340	360	360		
Power (max.)	W	850	1300	1400	1400		
Frequency   Voltage	Hz   V	50-60   220-240		50-60   220-240	50   220-240		
Dimensions (LxWxH)	mm	160 x 240 x 426		328 x 258 x 661	374 x 201 x 296		
<b>Equipments</b>		<ul style="list-style-type: none"> <li>» Integrated water filter</li> <li>» Garden hose adapter A3/4"</li> <li>» High pressure hose, 3 m</li> <li>» Trigger Gun Easy Connect</li> <li>» Extension lance</li> <li>» Spray lance</li> <li>» Integrated detergent hose</li> <li>» Dirt blaster (K 2.050 only)</li> </ul>		<ul style="list-style-type: none"> <li>» Integrated fine mesh water filter</li> <li>» Garden hose adapter A3/4"</li> <li>» High-pressure hose 6 m</li> <li>» Detergent application via suction</li> <li>» Vario-power spray lance</li> <li>» Dirt blaster</li> <li>» Wash brush</li> </ul>		<ul style="list-style-type: none"> <li>» Integrated fine mesh water filter</li> <li>» Short trigger gun</li> <li>» High-pressure hose 7.5 m</li> <li>» Detergent application via suction</li> <li>» Extension lance</li> <li>» Vario power jet 3600</li> <li>» Velcro tape</li> </ul>	

Powerful and durable water-cooled motors pressure cleaners which are ideally suited for occasional use on moderate dirt, from fences, balconies, bicycles and vehicles. Equipped with Vario Power spray lance for sensitive surfaces and Dirt Blaster to remove stubborn dirt. The state-of-the-art water-cooled motor is very impressive with its long service life and high level of performance.

Motor induksi dan berpendingin air yang kuat dan tahan lama, cocok untuk kebutuhan menengah sehari-hari, untuk membersihkan pagar, balkon, sepeda dan kendaraan lain. Dilengkapi dengan penyemprot Vario Power untuk permukaan sensitif dan Dirt Blaster untuk kotoran membandel. Teknologi motor berpendingin air yang sangat maju sungguh mengesankan menghasilkan umur pakai yang panjang dan performa yang tinggi.



**NEW**

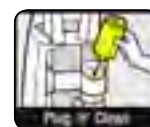
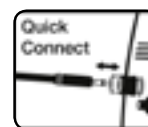
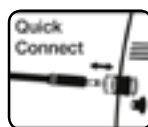
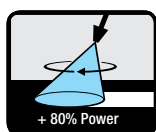

**Special Features**

- Long-life water cooled motor
- Vario Power
- 80% more power dirt blasting

- Long-life water cooled motor
- Vario Power
- 80% more power dirt blasting
- Quick Connect
- Cleaning agent hose

- Long-life water cooled motor
- Vario Power
- 80% more power dirt blasting
- Quick Connect
- High-pressure hose reel
- Plug 'n' Clean detergent system

Product (order n.)		K 3.450 (1.601-756.0)	K 3.500 (1.180-100.0)	K 5 Premium (1.181-313.0)
<b>Technical Data</b>				
Pressure (max.)	bar	120	120	145
Flow rate (max.)	l/h	378	420	500
Power (max.)	W	1700	1800	2100
Frequency   Voltage	Hz   V	50   230	50   230	50   230
Dimensions (LxWxH)	mm	315 x 321 x 855	285 x 325 x 876	349 x 426 x 878
<b>Equipments</b>				
		<ul style="list-style-type: none"> <li>» Garden hose adapter</li> <li>» High-pressure hose</li> <li>» Hand trigger gun</li> <li>» Vario-power spray lance</li> <li>» Dirt blaster</li> </ul>	<ul style="list-style-type: none"> <li>» Integrated fine mesh water filter</li> <li>» Garden hose adapter A3/4"</li> <li>» High-pressure hose 6 m</li> <li>» Detergent suction hose with filter</li> <li>» Trigger gun with Quick Connect</li> <li>» Vario-power spray lance</li> <li>» Dirt blaster</li> </ul>	<ul style="list-style-type: none"> <li>» High-pressure hose 8 m</li> <li>» Vario-power spray lance</li> <li>» Dirt Blaster</li> <li>» 1L Plug 'n' Clean detergent</li> <li>» Universal cleaner</li> <li>» Telescopic handle</li> </ul>



# Wet & Dry Vacuum Cleaners

Whether dry or moist, coarse or fine dirt – it makes no difference to Kärcher multi-purpose vacuum cleaners. With lower power consumption and innovative new accessories & features, these versatile units ensure cleanliness without compromise. Kärcher provides the right solution for any need – both for intensive as well as occasional use.

Kering atau basah, butiran kasar atau kecil, tidak menjadi masalah bagi vakum pembersih multi fungsi buatan Kärcher. Dengan konsumsi listrik lebih rendah beserta perangkat aksesoris dan fitur inovatif yang baru, mesin pembersih serba guna ini membersihkan tanpa kompromi. Kärcher memberikan solusi terbaik untuk setiap kebutuhan intensif maupun sehari-hari.

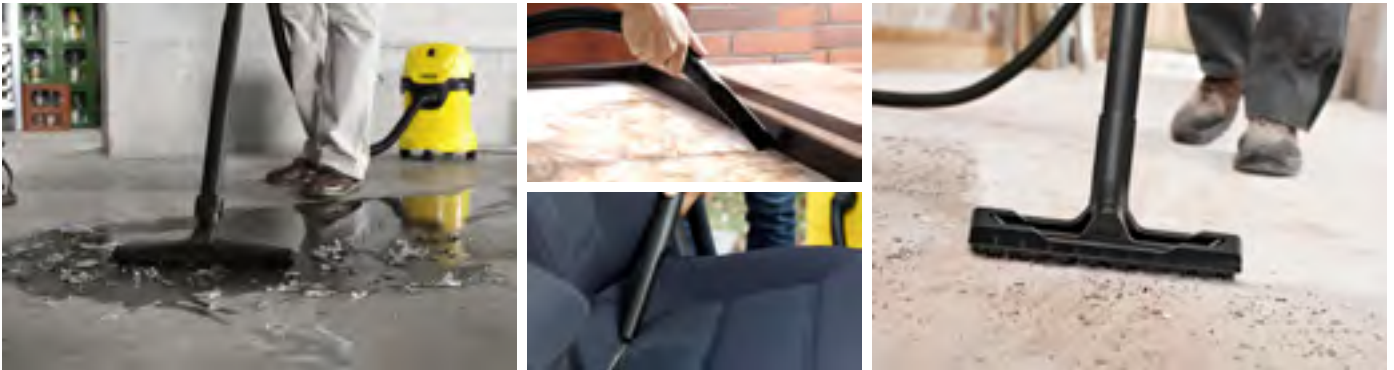

reddot award 2014  
honourable mention



## Special Features

- High suction power with only 1000 W energy use
- Accessory storage

- High suction power with only 1000 W energy use
- Electrostatic Protector
- Blower function
- Parking position
- Accessory storage

Product (order n.)		WD 2 Cartridge Filter Kit (1.629-764.0)	WD 3 Premium (1.629-840.0)
<b>Technical Data</b>			
Power (max.)	W	1200	1400
Container	l	12 - Plastic	17 - Stainless steel
Cable length	m	4	4
Weight (without acc.)	kg	4.5	5.8
Dimensions (LxWxH)	mm	369 x 337 x 430	388 x 340 x 525
<b>Equipments</b>		<ul style="list-style-type: none"> <li>» Filter bag</li> <li>» Cartridge filter</li> <li>» Suction hose, 2 m</li> <li>» Suction pipes, 0.5 m (2 pcs.)</li> <li>» Wet &amp; dry floor nozzle, clips</li> <li>» Crevice nozzle</li> </ul>	<ul style="list-style-type: none"> <li>» Filter bag</li> <li>» Cartridge filter</li> <li>» Suction hose, 2 m</li> <li>» Suction pipes, 0.5 m (2 pcs.)</li> <li>» Wet &amp; dry floor nozzle, clips</li> <li>» Crevice nozzle</li> </ul>



reddot award 2014  
honourable mention



**Special Features**

- Extreme suction power with only 1000 W energy use
- Easy filter changing
- Electrostatic Protector
- Parking position
- Accessory storage

- Extreme suction power with only 1100 W energy use
- Integrated filter cleaning
- Easy filter changing
- Electrostatic Protector
- Blower function
- Parking position
- Accessory storage

Product (order n.)		WD 4 Premium (1.348-150.0)	WD 5 Premium (1.348-230.0)
<b>Technical Data</b>			
Power (max.)	W	1600	1800
Container	l	20 - Stainless steel	25 - Stainless steel
Cable length	m	5	5
Weight (without acc.)	kg	7.5	8.7
Dimensions (LxWxH)	mm	384 x 365 x 526	418 x 382 x 652
<b>Equipments</b>		<ul style="list-style-type: none"> <li>» Fleece filter bag</li> <li>» Flat pleated filter</li> <li>» Suction hose, 2.2 m</li> <li>» Suction pipes, 0.5 m (2 pcs.)</li> <li>» Wet &amp; Dry floor nozzle, clips</li> <li>» Crevice nozzle</li> </ul>	<ul style="list-style-type: none"> <li>» Fleece filter bag</li> <li>» Flat pleated filter</li> <li>» Suction hose, 2.2 m</li> <li>» Suction pipes, 0.5 m (2 pcs.)</li> <li>» Change-over floor nozzle</li> <li>» Crevice nozzle</li> </ul>

# Dry Vacuum Cleaners

The ERP version stands for efficient cleaning with less power. The VC 2 & VC 3 come with HEPA 12 filter (captures 99.5% of dust and particles) and compact designs, makes them easier for storage. VC 2 is equipped with easy handling dust bag system; just throw away, no touch with dirt. VC 3 is the new advanced multi-cyclone vacuum cleaner, offers thorough cleaning without suction loss with three-level noise control system. Only 76 - 78 dB(A), no filter bag needed, big money saving.

Versi ERP dimaksudkan untuk pembersihan efektif dengan konsumsi daya yang lebih rendah. Pengisap kotoran kering ini menggunakan penyaring HEPA 12 (menyaring 99.5% debu & partikel) dan desain yang praktis, sehingga mudah disimpan. VC 2 dilengkapi dengan sistem kantong debu yang mudah digunakan, dapat langsung dibuang tanpa bersentuhan dengan kotoran. VC 3 menggunakan teknologi advanced multi-cyclone baru, menawarkan pembersihan menyeluruh tanpa kehilangan kekuatan isap dengan 3-level sistem pengatur kebisingan. Hanya 76-78 dB(A), tanpa kantong penyaring, sangat menghemat biaya.

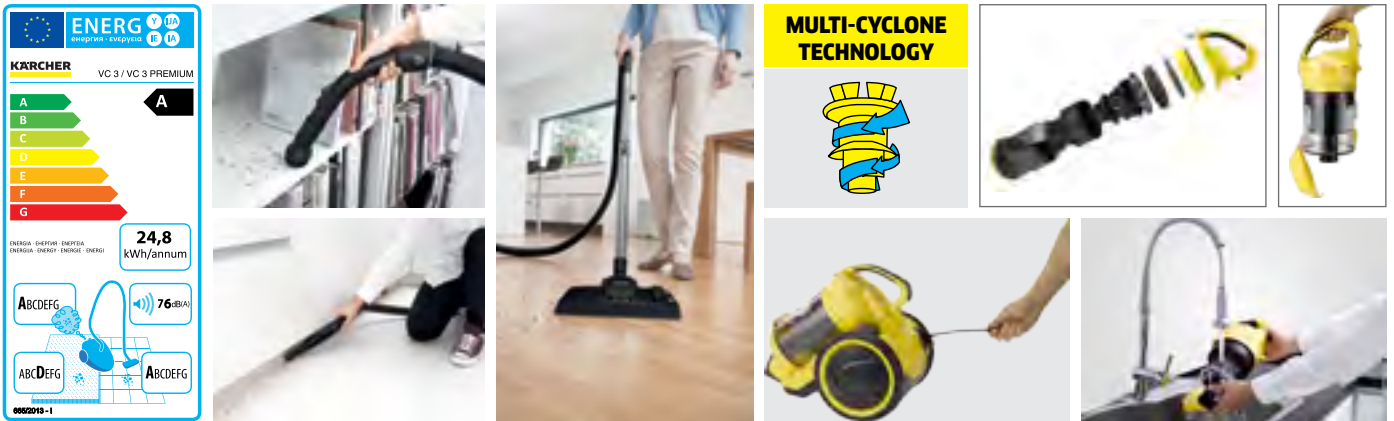

**NEW**



**NEW**



**BAG LESS**



## Special Features

- 3-layer air purification system
- Dust bag-full indicator
- Accessories compartment
- Automatic cable rewind
- HEPA 12 filter - captures 99.5% of dust & particles

- True multi-cyclone technology - outstanding performance, no suction loss
- 4-level filtering system
- Automatic cable rewind
- HEPA 12 filter - captures 99.5% of dust & particles

Product (order n.)		VC 2 (ERP) (1.198-103.0)	VC 3 (ERP) (1.198-123.0)
<b>Technical Data</b>			
Power Rating   Suction	W	700   180	700   150
Container	l	2, dust bag	0.6
Cable length	m	5	5
Noise level	db(A)	76	76
Dimensions (LxWxH)	mm	250 x 288 x 435	332 x 270 x 396
<b>Equipments</b>		<ul style="list-style-type: none"> <li>» Floor nozzle</li> <li>» Crevice nozzle</li> <li>» Brush nozzle</li> <li>» Dust bag</li> <li>» Suction hose</li> <li>» Suction pipes, 0.5 m (2 pcs.)</li> </ul>	<ul style="list-style-type: none"> <li>» Floor nozzle</li> <li>» Crevice nozzle</li> <li>» Brush nozzle</li> <li>» Suction hose</li> <li>» Suction pipes, 0.5 m (2 pcs.)</li> </ul>



VC 6300 is a combination of extreme suction power with outstanding comfort features. With the QuickClick system, it is so easy to switch nozzles, while EasySlider rotating ring protects objects from damage and makes it easy to vacuum without interruptions.

VC 6300 merupakan kombinasi antara kekuatan isap yang ekstrim dengan fitur kenyamanan yang luar biasa. Sistem QuickClick sangat memudahkan penggantian cerat, sedangkan EasySlider melindungi objek dari kerusakan dan memudahkan bekerja tanpa gangguan.

### Vacuum Cleaner with Water Filter

The multi-stage filter system (water filter & HEPA 12) of DS 5.800 ensures that even microscopic dirt particles as small as 0.3 µm are extracted. This is ideal for families with young children or people with allergies. The DS 5.800 relies on the natural power of water being swirled around at high speed. The dirt is piped through the swirling water, reliably filtered from the air, and bound in the water. The result: exceptionally fresh, 99.9% clean exhaust air.

Sistem penyaringan berjenjang (penyaringan air dan HEPA 12) dari DS 5.800 menjamin bahkan partikel debu sekecil 0.3 mikrometer tersaring. Alat ini ideal untuk keluarga dengan anak-anak atau mereka yang memiliki alergi. DS 5.800 mengandalkan kekuatan alami air yang dilingkarkan dengan kecepatan tinggi. Kotoran disalurkan melalui air yang berputar, tersaring dari udara dan terperangkap di air. Hasilnya: udara buangan yang sangat bersih (99.9%).

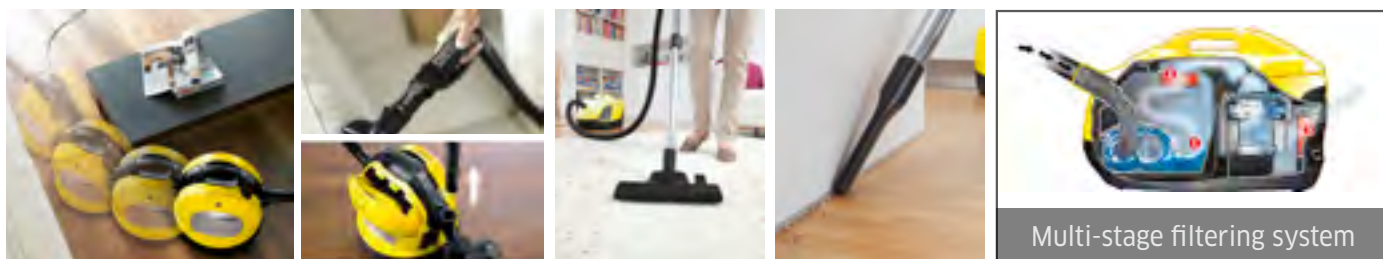

#### Special Features

- EasySlider bumper
- Remote control on the handle
- Filter change indicator
- QuickClick accessory switch system
- HEPA 12 filter - captures 99.5% of dust & particles
- Multi-stage filter system - for 99.9 % clean air
- HEPA 12 filter - captures 99.5% of dust & particles
- Exceptionally easy water filter cleaning
- Parking position & accessory storage on machine

Product (order n.)		VC 6300 (1.195-541.0)	DS 5.800 (1.195-210.0)
<b>Technical Data</b>			
Power (max.)	W	2000	900
Container	l	4, fleece filter bag	2, water filter
Cable length	m	6.5	6.5
Weight (without acc.)	kg	7	7.4
Dimensions (LxWxH)	mm	380 x 370 x 370	535x289x345
<b>Equipments</b>		<ul style="list-style-type: none"> <li>» Comfoglide Floor nozzle</li> <li>» Crevice nozzle</li> <li>» Furniture brush nozzle</li> <li>» Upholstery nozzle</li> <li>» Fleece filter bag</li> <li>» Suction hose, 2.3 m</li> <li>» Suction pipes, 0.5 m (2 pcs.)</li> </ul>	<ul style="list-style-type: none"> <li>» Switchable floor nozzle</li> <li>» Crevice nozzle</li> <li>» Upholstery nozzle</li> <li>» HEPA 12 filter</li> <li>» Telescopic suction tube</li> <li>» Motor filter</li> <li>» "Foam stop" defoamer</li> </ul>

# Steam Cleaners

Steam cleaning is suitable for any home, whether for singles, small or large families. Microscopic steam particles penetrate even the smallest pores. In this way they dissolve stubborn dirt and prevent bacterial and microbial growth. Since cleaning with steam does not involve the use of cleaning agents, no allergenic residues can form on cleaned surfaces. Kärcher steam cleaners are extremely versatile and clean without chemicals.

Membersihkan dengan uap panas cocok dipakai di rumah, baik keluarga kecil maupun besar. Penetrasi partikel uap panasnya mencapai hingga ke pori-pori terkecil. Dengan demikian dapat menghilangkan kotoran membandel serta mencegah berkembang biaknya bakteri dan mikroba. Karena tidak menggunakan cairan kimia, pembersih uap panas ini tidak meninggalkan residu pada permukaan. Pembersih uap panas dari Kärcher sangat serbaguna dan membersihkan tanpa menggunakan bahan kimia.



100 °C



Dirt-blasting Pressure

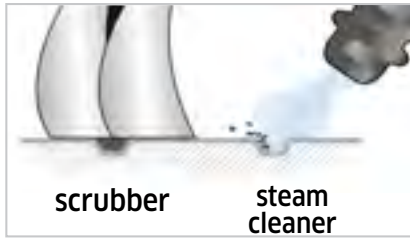

scrubber

steam cleaner



**DEEP CLEANING WITHOUT CHEMICALS**

Kills **99.99%** Bacteria



- Special Features**
- Extremely compact - very easy to be stored
  - Practical handle

Product (order n.)		SC 1 Premium + Floor Kit (1.516-226.0)
<b>Technical Data</b>		
Power (max.)	W	1200
Area performance	m2	20
Tank capacity	l	0.2
Heating time	min.	3
Steam pressure (max.)	bar	3
<b>Equipments</b>		
» Childproof safety lock		» Tubes
» Safety valve		» Hand nozzle cloth
» Hand nozzle		» Floor nozzle cloth
» Floor nozzle		» Round brush
» Detail nozzle		» Accessory bag
» Power nozzle		
» Extension hose		

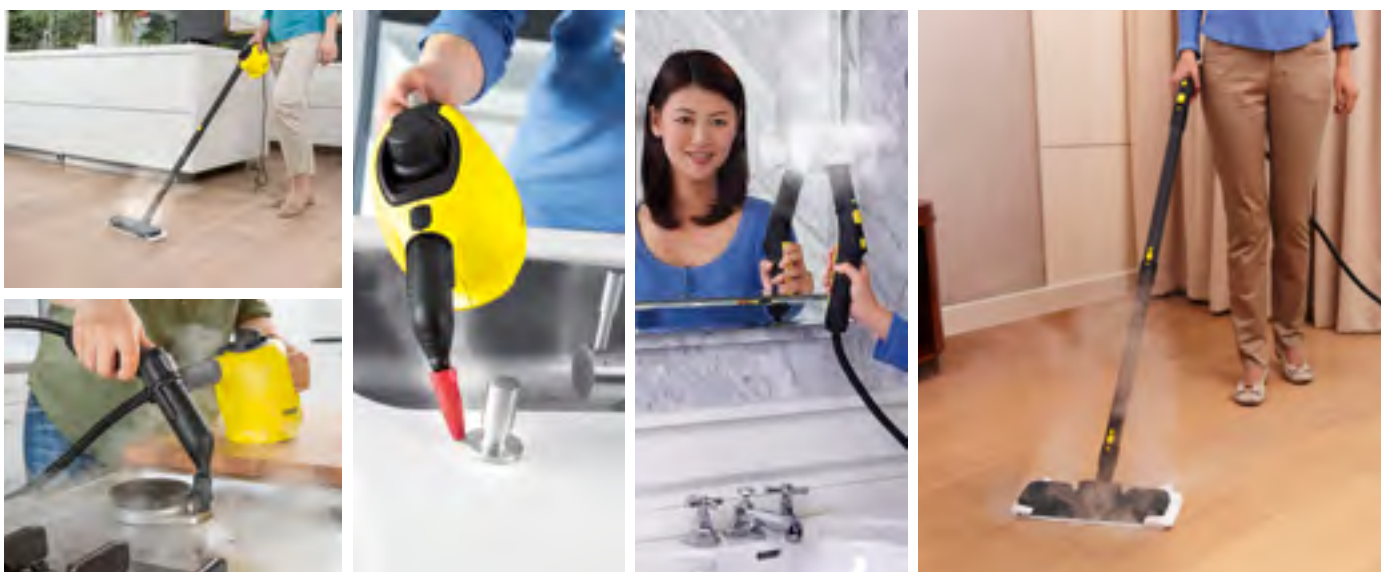

**NEW**



**Special Features**

- Light, compact device
- Ergonomic carrying handle
- Continuous operation with 2 tank system
- Detachable tank
- Power cord storage compartment
- Fast heat-up time

Product (order n.)		SC 2 (1.512-006.0)	SC 2.500 C (1.512-350.0)
<b>Technical Data</b>			
Power (max.)	W	1500	1500
Area performance	m2	75	-
Tank capacity	l	1	0,5 + 0.8 (detachable tank)
Heating time	min.	6.5	6
Steam pressure (max.)	bar	3.2	3.2
<b>Equipments</b>		<ul style="list-style-type: none"> <li>» Childproof safety lock</li> <li>» Safety valve</li> <li>» Detail nozzle</li> <li>» Hand nozzle</li> <li>» Round brush black</li> <li>» Descaler sticks</li> </ul>	<ul style="list-style-type: none"> <li>» Childproof safety lock</li> <li>» Safety valve</li> <li>» Trigger Gun with steam hose, 2 m</li> <li>» Extension tubes 2 x 0.5 m</li> <li>» Detail nozzle</li> <li>» Hand nozzle</li> <li>» Floor nozzle</li> <li>» Round brush black</li> <li>» Cover terry cloth</li> <li>» Floor terry cloth</li> <li>» Descaler sticks</li> </ul>



# Window Cleaner

## Cleaning Windows Without Drips, Streaks and Stress

The Kärcher WV cleans smooth surfaces including windows, tiles, mirrors, etc. saving trouble and time. Its innovative water suction takes up the dirty water - hygienically without leaving streaks behind.

Pembersih jendela dari Kärcher membersihkan permukaan datar termasuk jendela, keramik, cermin, dll. Mudah dan menghemat waktu, pengisap airnya yang inovatif mengisap air kotor secara higienis tanpa meninggalkan bekas.



# Cordless Electric Broom

## Faster Than a Broom - More Convenient Than a Vacuum

Remove all kinds of dirt including pet hair from all surfaces. Ideal for quick clean-ups on carpets, laminate or tiles, whenever the usage of a vacuum is too complicated.

Membersihkan semua jenis kotoran termasuk bulu binatang piaraan dari semua jenis permukaan. Ideal untuk membersihkan karpet, lantai vinyl atau keramik saat menggunakan mesin vacuum terlalu rumit.

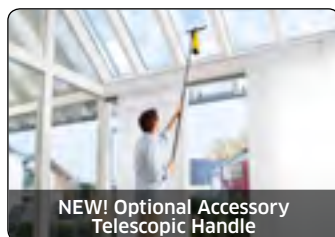
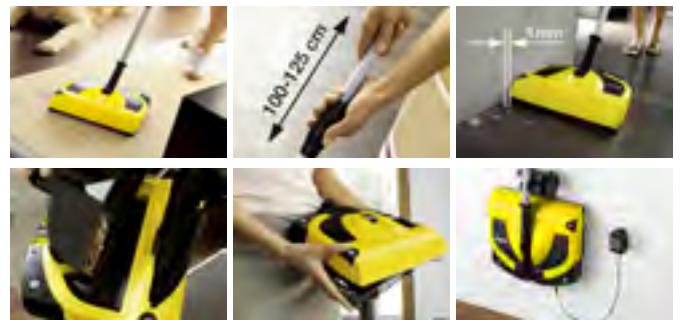

### Special Features

- No drips, no streaks
- Electrical water suction

- Easy removal dirt & pet hair
- Adjustable handle
- Compact storage

Product (order n.)		WV 50 Plus (1.633-117.0)
<b>Technical Data</b>		
Performance/charge	m <sup>2</sup>	approx. 60 (20 windows)
Dirty water container	ml	100
Battery runtime	min.	20
Dimensions (LxWxH)	mm	130x90x355
Weight (with battery)	kg	0.7
<b>Equipments</b>		
» Suction nozzle, width 280 mm » Lithium-ion battery » Battery charger » Spray bottle with microfiber cloth » Window cleaner concentrate, 20 ml		

Product (order n.)		K 55 Plus (1.258-509.0)
<b>Technical Data</b>		
Performance/charge	m <sup>2</sup>	60-100
Container	l	0.5
Battery voltage	V	4.8
Dimensions (LxWxH)	mm	260x300x96
Weight (with battery)	kg	2.1
<b>Equipments</b>		
» Battery charger » Long-life rechargeable battery » Standard brush, working width 265 mm » Pet hair brush, working width 235 mm » Wall bracket		

# Submersible Pump

## Compact, Robust & Powerful

The powerful and convenient Kärcher Drainage Pumps provide fast and reliable assistance when draining ponds, pools or cellars. The pump can adjust to different conditions with its adjustable pumping rhythm and switches on and off at exactly the right time.

*Pompa air Kärcher merupakan alat bantu yang kuat, cepat dan dapat dipercaya untuk menguras kolam ikan, kolam renang dan tangki. Pompa ini dapat disesuaikan dengan kondisi berbeda dengan mengubah ritme pompa dan menyala tepat pada saat ditentukan.*



# Hose Reel

## Innovative Hose Reel

Kärcher's innovative hose storage systems set new standards in terms of functionality, design and quality. Its modern hose trolleys permit users to quickly roll up and unroll the hose without having to keep it in place manually – with minimal space required.

*Inovasi Kärcher untuk sistem penyimpanan selang menetapkan standar baru pada fungsi desain dan kualitas. Troli selang modernnya memudahkan pengguna untuk membuka dan menggulung selang secara cepat dan efisien tempat.*



### Special Features

- Possibility to fix the float switch

- Hose carrier with 15 m 1/2" standard hose, spray nozzle 2.645-053
- Easy to carry
- Product designation with scroll label
- Ready to use

Product (order n.)		SP 3 (1.645-502.0)
<b>Technical Data</b>		
Motor rating	W	350
Flow rate (max.)	l/h	7000
Delivery height/pressure	m/bar	6/0.6
Immersion depth	m	7
Temperature	°C	35
<b>Equipments</b>		» Quick connect » Hose connection piece, 1 1/4"

Product (order n.)		HR 25 (2.645-041.0)
<b>Technical Data</b>		
Hose length	m	15
Hose diameter	in.	0.5
Connector	pc.	4
Dimensions (LxWxH)	mm	300x300x300
<b>Equipments</b>		» G3/4-tap connection

# Home & Garden Accessories

High Pressure Cleaner Accessories		Order Number	Description	K1	K 2.050	K 2.360	K 2.420 Air Con	K 3.450	K 3.500	K 5 Premium
		1. Universal Cleaner (0.5 l)	6.295-385.0	Cleaning agent concentrate for all purpose	<input type="checkbox"/>	<input type="checkbox"/>	<input type="checkbox"/>	<input type="checkbox"/>	<input type="checkbox"/>	<input type="checkbox"/>
		2. FJ 3 Foam Jet (0.3 l)	2.643-150.0	Powerful foam application	<input type="checkbox"/>	<input type="checkbox"/>	<input type="checkbox"/>	<input type="checkbox"/>	<input type="checkbox"/>	<input type="checkbox"/>
		3. DB 145 Dirt Blaster	2.643-244.0	Powerful rotary nozzle for very stubborn dirt, mossy or weather-worn surfaces	<input type="checkbox"/>	<input checked="" type="checkbox"/>	<input checked="" type="checkbox"/>	<input type="checkbox"/>	<input checked="" type="checkbox"/>	<input checked="" type="checkbox"/>
		4. HK 7.5 High Pressure Hose	2.641-828.0	Complete set of trigger gun and hose	<input type="checkbox"/>	<input type="checkbox"/>	<input type="checkbox"/>	<input type="checkbox"/>	<input type="checkbox"/>	<input type="checkbox"/>
		5. HK 4 (4 m) High Pressure Hose Kit	2.643-312.0	Complete set of trigger gun, hose (4m) and adaptor for Quick Connect system	<input type="checkbox"/>	<input type="checkbox"/>	<input type="checkbox"/>	<input type="checkbox"/>	<input type="checkbox"/>	<input type="checkbox"/>
		6. G 160 Q Trigger Gun QuickConnect	2.642-782.0	Quick connect trigger gun with soft grip	<input type="checkbox"/>	<input type="checkbox"/>	<input type="checkbox"/>	<input type="checkbox"/>	<input checked="" type="checkbox"/>	<input checked="" type="checkbox"/>
		7. VP 120 Vario Power Jet	2.643-241.0	Adjustable pressure control spray lance	<input type="checkbox"/>	<input type="checkbox"/>	<input checked="" type="checkbox"/>	<input type="checkbox"/>	<input type="checkbox"/>	<input type="checkbox"/>
		8. VP 145 Vario Power Jet	2.643-235.0	Adjustable pressure control spray lance	<input type="checkbox"/>	<input type="checkbox"/>	<input type="checkbox"/>	<input checked="" type="checkbox"/>	<input checked="" type="checkbox"/>	<input type="checkbox"/>
		9. MP 145 Multi Power Jet	2.643-239.0	Nozzle with 5 spray types: detergent jet, high pressure flat stream, rotary nozzle, point jet and wide	<input type="checkbox"/>	<input type="checkbox"/>	<input type="checkbox"/>	<input type="checkbox"/>	<input type="checkbox"/>	<input type="checkbox"/>
		10. VPS 145 S Vario Power Jet Short	2.643-253.0	Adjustable 360° joint is ideal to clean confined, hard-to-reach spaces	<input type="checkbox"/>	<input type="checkbox"/>	<input type="checkbox"/>	<input checked="" type="checkbox"/>	<input type="checkbox"/>	<input type="checkbox"/>
		11. VPS 160 S Vario Power Jet Short	2.643-254.0	Adjustable 360° joint is ideal to clean confined, hard-to-reach spaces	<input type="checkbox"/>	<input type="checkbox"/>	<input type="checkbox"/>	<input type="checkbox"/>	<input type="checkbox"/>	<input checked="" type="checkbox"/>
		12. T 250 Plus T-Racer	2.642-782.0	Splash-free cleaning of various surfaces	<input type="checkbox"/>	<input type="checkbox"/>	<input type="checkbox"/>	<input type="checkbox"/>	<input type="checkbox"/>	<input type="checkbox"/>
		13. PS 40 Surface Cleaner	2.643-245.0	Remove stubborn dirt from wide variety of surfaces	<input type="checkbox"/>	<input type="checkbox"/>	<input type="checkbox"/>	<input type="checkbox"/>	<input type="checkbox"/>	<input type="checkbox"/>
		14. PS 20 Surface Cleaner	2.643-558.0	Cleaning variety surfaces	<input type="checkbox"/>	<input type="checkbox"/>	<input type="checkbox"/>	<input type="checkbox"/>	<input type="checkbox"/>	<input type="checkbox"/>
		15. Wash Brush	2.642-783.0	Gentle cleaning	<input type="checkbox"/>	<input type="checkbox"/>	<input checked="" type="checkbox"/>	<input type="checkbox"/>	<input type="checkbox"/>	<input type="checkbox"/>
		16. Rotating Wash Brush	2.642-786.0	Adjustable 180 degree joint on handle to clean hard-to-reach places	<input type="checkbox"/>	<input type="checkbox"/>	<input type="checkbox"/>	<input type="checkbox"/>	<input type="checkbox"/>	<input type="checkbox"/>
		17. WB 150 Power Brush	2.643-237.0	Splash-free cleaning of sensitive surfaces	<input type="checkbox"/>	<input type="checkbox"/>	<input type="checkbox"/>	<input type="checkbox"/>	<input type="checkbox"/>	<input type="checkbox"/>
		18. H9 Q High Pressure Hose Quick Connect	2.641-721.0	Replacement hose with Quick Connect	<input type="checkbox"/>	<input type="checkbox"/>	<input type="checkbox"/>	<input type="checkbox"/>	<input type="checkbox"/>	<input type="checkbox"/>
		19. Pipe Cleaning Kit (7.5 m)	2.642-790.0	For effective cleaning and removal of blockages in pipes, drains, downpipes & toilets	<input type="checkbox"/>	<input type="checkbox"/>	<input type="checkbox"/>	<input type="checkbox"/>	<input type="checkbox"/>	<input type="checkbox"/>
		20. SH 3 Suction Hose (3 m)	2.643-101.0	Allows water to be drawn from alternative sources	<input type="checkbox"/>	<input type="checkbox"/>	<input type="checkbox"/>	<input type="checkbox"/>	<input type="checkbox"/>	<input type="checkbox"/>

Wet & Dry Vacuum Cleaners & Dry Vacuum Cleaners Accessories		Order Number	Description	WD 2	WD 3 Premium	WD 4 Premium	WD 5 Premium	DS 5.800
		1. Suction brush with soft bristles	2.863-147.0	For gentle cleaning of sensitive car interior surfaces	<input type="checkbox"/>	<input type="checkbox"/>	<input type="checkbox"/>	<input type="checkbox"/>
		2. Suction brush with hard bristles	2.863-146.0	For easy removing dried-on dirt	<input type="checkbox"/>	<input type="checkbox"/>	<input type="checkbox"/>	<input type="checkbox"/>
		3. Extra long crevice Nozzle (350 mm)	2.863-144.0	Ideal for cleaning hard-to-reach places	<input type="checkbox"/>	<input type="checkbox"/>	<input type="checkbox"/>	<input type="checkbox"/>
		4. Car Vacuuming nozzle	2.863-145.0	For quick and easy cleaning of car seats, carpeted surfaces, boot and foot well	<input type="checkbox"/>	<input type="checkbox"/>	<input type="checkbox"/>	<input type="checkbox"/>
		5. Changeover WD nozzle	2.863-000.0	Switchable wet & dry floor nozzle for optimum dirt pick-up	<input type="checkbox"/>	<input type="checkbox"/>	<input type="checkbox"/>	<input checked="" type="checkbox"/>
		6. Turbo Upholstery Nozzle	2.903-001.0	For cleaning upholstery, chairs, pillows, bed etc.	<input type="checkbox"/>	<input type="checkbox"/>	<input type="checkbox"/>	<input type="checkbox"/>

Optional Accessories

Included equipment



Steam Cleaners Accessories		Order Number	Description	SC 1 Prim. + FK	SC 2	SC 2.500 C
	1	2.863-058.0	1. Round Brush Set (4 pieces)	<input type="checkbox"/>	<input type="checkbox"/>	<input type="checkbox"/>
	2	2.863-140.0	2. Round brush with scraper	<input type="checkbox"/>	<input type="checkbox"/>	<input type="checkbox"/>
	3	2.863-061.0	3. Round brush set - brass bristles (3 pieces)	<input type="checkbox"/>	<input type="checkbox"/>	<input type="checkbox"/>
	4	2.863-215.0	4. Multi-purpose accessory kit	<input type="checkbox"/>	<input type="checkbox"/>	<input type="checkbox"/>
	5	4.130-390.0	5. Textile care nozzle	<input type="checkbox"/>	<input type="checkbox"/>	<input type="checkbox"/>
	6	2.884-282.0	6. Extension and power nozzle	<input type="checkbox"/>	<input type="checkbox"/>	<input type="checkbox"/>
	7	2.863-159.0	7. Steam Turbo Brush	<input type="checkbox"/>	<input type="checkbox"/>	<input type="checkbox"/>
	8	4.130-115.0	8. Window nozzle for steam cleaners	<input type="checkbox"/>	<input type="checkbox"/>	<input type="checkbox"/>
	9	2.884-278.0	9. Wide floor nozzle 315 mm	<input type="checkbox"/>	<input type="checkbox"/>	<input type="checkbox"/>
	10	2.863-171.0	10. Bathroom microfibre cloths set (4 pieces)	<input type="checkbox"/>	<input type="checkbox"/>	<input type="checkbox"/>
	11	2.863-172.0	11. Kitchen microfibre cloths (4 pieces)	<input type="checkbox"/>	<input type="checkbox"/>	<input type="checkbox"/>
	12	2.863-173.0	12. Floor microfibre cloths (2 pc.)	<input type="checkbox"/>	<input type="checkbox"/>	<input type="checkbox"/>

Garden Watering System		Order Number	Description
	1	2.645-053.0	1. Nozzle
	2	2.645-105.0	2. Spray Gun
	3	2.645-051.0	3. Multi Functional Spray Nozzle
	4	2.645-047.0	4. Premium Multi Functional Spray Gun
	5	2.645-046.0	5. Premium Metal Spray Gun
	6	2.645-006.0	6. Tap Adaptor
	7	2.645-194.0	7. Universal Hose Connector Plus
	8	2.645-193.0	8. Universal Hose Connector Plus
	9	2.645-196.0	9. Premium Universal Hose Connector
	10	2.645-195.0	10. Premium Universal Hose Connector

Optional Accessories

Included equipment



Please contact us for more information:

#### Kärcher Center Jakarta

Komplek Sudirman Park Blok A6-A7  
Jl. K. H. Mas Mansyur Kav. 35  
Jakarta 10220  
Phone +62 21 8065 7600  
Email info@id.kaercher.com

#### Kärcher Stores - Service Center & Authorised Dealers

##### DKI Jakarta

**PT Panatek Mulya Sejahtera** ○ ■  
Pertokoan Glodok Jaya No.38-39  
Jl. Hayam Wuruk  
Mangga Besar 11180  
Phone +62 21 6255 506  
Email sales@panatek.co.id

**PT Weld-Tech Indonesia** ○ ■  
Pergudangan Green Sedayu Biz Park  
Blok DM-1 No. 90  
Jln. Daan Mogot Raya KM. 18  
Jakarta Barat 11840  
Phone +62 21 22 522 777  
Email sales@weldtech-indo.com

##### Banten

**PT Bumi Bangun Perkasa** ○ ■  
Golden Road, Block C. 28  
No. 10, ITC BSD  
Tangerang Selatan 15310  
Phone +62 21 5315 2793  
Email marketing@bumibangun.com

**PT Kawan Baru Teknik** ○ ■  
Komplek Ruko Cilegon City Square  
Blok G 10 PCI  
Cilegon 42423  
Phone +62 254 375765  
+62 254 387163  
Email info@kawanbaruteknik.com

##### Jawa Barat

###### Kärcher Store Uap Air

Jl. Suniaraja No. 29 A  
Bandung 40111  
Phone +62 22 8588 0101  
+62 22 8588 0102  
+62 22 8588 0103  
Email pt\_uapair@yahoo.co.id

**Sumber Teknik** ○ ■  
Jl. Mayjend Didi Kartasasmita 988  
Kota Banjar  
Phone +62 265 2733 312  
+62 265 2733 313  
Email sumberteknik.pwt@yahoo.co.id

**PT Perakasku Multi Cemerlang** ○ ■  
Jl. Jend. A. Yani 350  
Bandung  
Phone +62 22 7271 396  
Email cs@perakasku.co.id

##### Jawa Tengah

**PT Sae Karisma Cemerlang** ○ ■  
Jl. Raya Solo Baru Blok AC 7  
Sukoharjo, Solo  
Phone +62 271 6223 95  
Email admin@saekarisma.com

**Sumber Teknik** ○ ■  
Jl. Gerilya No. 560 - 561  
Purwokerto  
Phone +62 281 6377 43  
+62 281 6381 58  
Email sumberteknik\_pwt@yahoo.co.id

**CV Anugerah Cipta Prima** ○ ■  
Jl. M. T. Haryono No. 8  
Semarang  
Phone +62 24 3546 030  
+62 24 3555 595  
Email acpsemarang@gmail.com

##### Jawa Timur

**Kärcher Store SAE Karunia Cemerlang**  
Jl. Raya Jemursari 100  
Surabaya  
Phone +62 31 8477 991  
Email cleanisfun@saekaruniacemerlang.com

**PT Panatek Mulya Sejahtera** ○ ■  
Jl. Pucang Anom Timur  
Surabaya  
Phone +62 31 5035 439  
Email sales@panatek.co.id

**CV Micro Jaya Abadi (Tools Station)** ○ ■  
Jl. Semarang B-16/118  
Bubutan-Bubutan  
Surabaya 60174  
Phone +62 31 5347368 (hunting)  
Email micro.surabaya@gmail.com

**Indocon Sukses Abadi** ○ ■  
Jl. Dupak 61  
Kompleks Best Land Blok A No. 9  
Surabaya 60179  
Phone +62 31 5455 788  
Email sales@indoconsa.com

**Depo Bangunan III** ○  
Komplek Central Square  
Jl. Raya A. Yani No. 41-43, Gedangan  
Waru-Sidoarjo 61254  
Phone +62 31 8557 060 (hunting)  
+62 31 8557 080  
Email depo03@sby.centrin.net.id

**Depo Bangunan IV** ○  
Jl. Raya Karanglo No. 69,  
Banjararum, Singosari  
Malang 65153  
Phone +62 341 4828 88 (hunting)  
Email depo03@sby.centrin.net.id

##### Bali

**Kärcher Store Altek Dewata**  
Jl. Gatot Subroto Timur No.36 A-B  
Kesiman, Denpasar 80239  
Phone +62 361 467610  
Email altekdwata@ud-nasional.com

**PT Bagoes Baliindo Jaya** ○ ■  
Jl. Raya Semebaung No.18  
Gianyar 80511  
Phone +62 361 9519 18  
Email tri\_dbb@yahoo.co.id

**Depo Bangunan VI** ○  
Jl. Teuku Umar Barat No. 388 (Malboro)  
Denpasar 80117  
Phone +62 361 8475 888  
Email depo03@sby.centrin.net.id

**CV Laksmi Dewata** ○ ■  
Jl. Dewata no. 26  
Denpasar 80224  
Phone +62 361 7291 65  
Email laksmi.dewata@gmail.com  
laksmi.dewata@yahoo.com

##### Sumatera Utara

**PT Faedah Teknik** ○ ■  
Jl. Bogor No.40  
Medan 20212  
Phone +62 61 4568 886  
Email faedahteknik@gmail.com

**PT Primanusa Jaya Mandiri** ○ ■  
Jl. Sidomulyo, Komplek Orlando  
Sidomulyo Residence No.11 F  
Medan  
Phone +62 61 8001 7065  
Email primanusa\_pjm@yahoo.co.id

##### Riau

**PT Yanmarindo Perkasa** ○ ■  
Jl. Riau No. 53 A-E  
Pekanbaru  
Phone +62 761 44000 (hunting)  
+62 761 44150  
+62 761 44154  
Email user@yanmarpekanbaru.com

**PT Rauda Global Sarana** ○ ■  
Jl. Tuanku Tambusai No. 320  
(di seberang Global Bangunan)  
Pekanbaru  
Phone +62 761 356 56  
Email raudaglobalsarana@gmail.com

##### Kepulauan Riau

**PT Citra Seraya** ○  
Jl. Gatot Subroto No. 98 A  
Tanjungpinang 29123  
Phone +62 771 2998 8  
+62 771 3138 88  
Email info@citraseraya.com

**PT Furniture Batam Bina Perkasa** ○  
Jalan Raden Patah No 4 - 6  
(di depan Hotel Mercure)  
Batam 29432  
Phone +62 778 4588 41  
+62 778 4578 71  
Email fb@hannsgroup.com

##### Sumatera Selatan

**PT Valendri Artha Tirta** ○  
Jl. Veteran No.1C Rt.022 Rw.007  
Kuto Batu, Ilir timur II  
Palembang 30111  
Phone +62 711 3100 64  
Email valendri.tools.center@gmail.com

##### Lampung

**PT Andalan Mitra Teknik** ○ ■  
Lampung Diesel  
Jl. P. Diponegoro No. 11 G  
Bandar Lampung 35111  
Phone +62 721 266777  
+62 721 258488  
+62 721 265565  
Email sales@lampungdiesel.com

##### Kalimantan Timur

**PT Bumi Bangun Perkasa** ○ ■  
Borneo Paradiso Ruko Mahogany A No. 7  
Jl. Mulawarman, Batakan  
Balikpapan 76115  
Phone +62 542 7571 079  
+62 542 7571 080  
Email marketing@bumibangun.com

**PT Central Jayatama Abadi** ○  
Jl. Letjend Suprpto No. 03  
Margasari, Balikpapan Barat  
Balikpapan 76131  
Phone +62 542 4215 50  
Email sales@central-bpn.com

##### Kalimantan Tengah

**Griya Samudra Supermarket** ○  
**Bahan Bangunan**  
Jl. Pangeran Antasari Blok 15-18  
Sampit  
Phone +62 531 31500

##### Sulawesi Utara

**Grand Prima** ○  
Jl. Pierre Tendean Boulevard  
Kompleks Blue Banter Blok A-1  
Manado  
Phone +62 431 8819 901  
Email grandmanado@gmail.com

##### Plaza Bangunan Electronic

○ ■  
Jl. Sisingamangaraja No. 45, Calaca  
Manado 95121  
Phone +62 431 8585 10  
Email purchasing.clc@plazabangunan.com

○ Home & Garden

■ Professional

www.Kaercher.co.id

☎ 0800 140 1551

✉ info@id.kaercher.com

🇮🇩 Kaercher Indonesia

📷 Kaercher.id

Dealer info: